

КЛЕММНЫЕ БЛОКИ > КЛЕММНЫЕ КОЛОДКИ С ВСТАВНЫМ КРЕПЛЕНИЕМ > МНОГОПРОВОДНЫЕ КЛЕММНЫЕ БЛОКИ

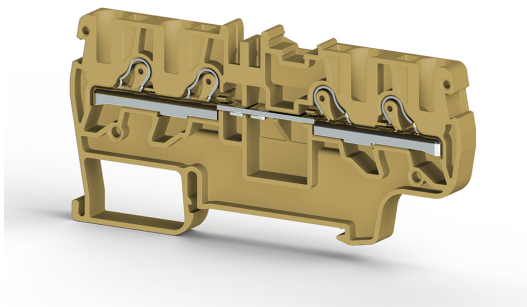

РҮК 4С Бежевый

Артикул (SKU): 307660

Push-In 4 мм² 2 вход-2 выход проходная

Коммерческая информация

Код продажи продукта	307660
Единица Упаковки	45 шт.
Номер таможенного тарифа	853690950000
Вес за единицу, включая упаковку	0.014177 kg.

Техническая информация

PRODUCT FEATURES	
Number of Connections	4
Color	Beige
Number of Levels	1
Insulation Material	PA
UL 94 Flammability Class	V2
Impulse Voltage Category	III
Insulation Material Group	I
Pollution Degree	3
Connection According to Standard	IEC 60947-7-1
Continuous Operating Temperature max.	120 °C
Continuous Operating Temperature min.	-55 °C
ELECTRICAL FEATURES	
Nominal Impulse Voltage	8 Kv

Nominal Current	32 A
Nominal Voltage	1000 V
Maximum Load Current	41 A

CONNECTION DATA

Connection Type	Push-In Connection
Single-core min. conductor cross-section	0,34 mm²
Single-core max. conductor cross-section	6 mm²
Conductor Cross Section Awgkcmil Min	22 AWG
Conductor Cross Section Awgkcmil Max	10 AWG
Multi-core min. conductor cross-section	0,25 mm²
Multi-core max. conductor cross-section	4 mm²
Multi-core min. conductor cross-section with ferrule	0,34 mm²
Multi-core max. conductor cross-section with ferrule	4 mm²
2 Conductors Of The Same Cross Section Multi Core Twin Ferrule With Plastic Sleeve Min	1 mm²
Min. Stripping Length	9 mm
Max. Stripping Length	10 mm
Internal cylindrical indicator	A4

DIMENSIONS

Width	6 mm
Length	85,70 mm
Height Mr 35X75	44 mm
Height MR 35x15	51,5 mm